



HASELBURY HOUSE,
MARYLEBONE, W1U
Asking Price £1,195,000 Leasehold

T. +44 (0) 20 7935 0011
E. enquire@napierwatt.co.uk
WWW.NAPIERWATT.CO.UK

NAPIER WATT

PROPERTY CONSULTANTS

Description

A recently renovated two bedroom, duplex apartment set within an excellent position within this newly built and renovated development in the heart of Marylebone on George Street. The property benefits from central air-conditioning system, lift & excellent security provided by 24 hour portage with CCTV. The property is conveniently located close to the famous shopping facilities of Selfridges, Oxford Street and the cosmopolitan restaurants in the area.

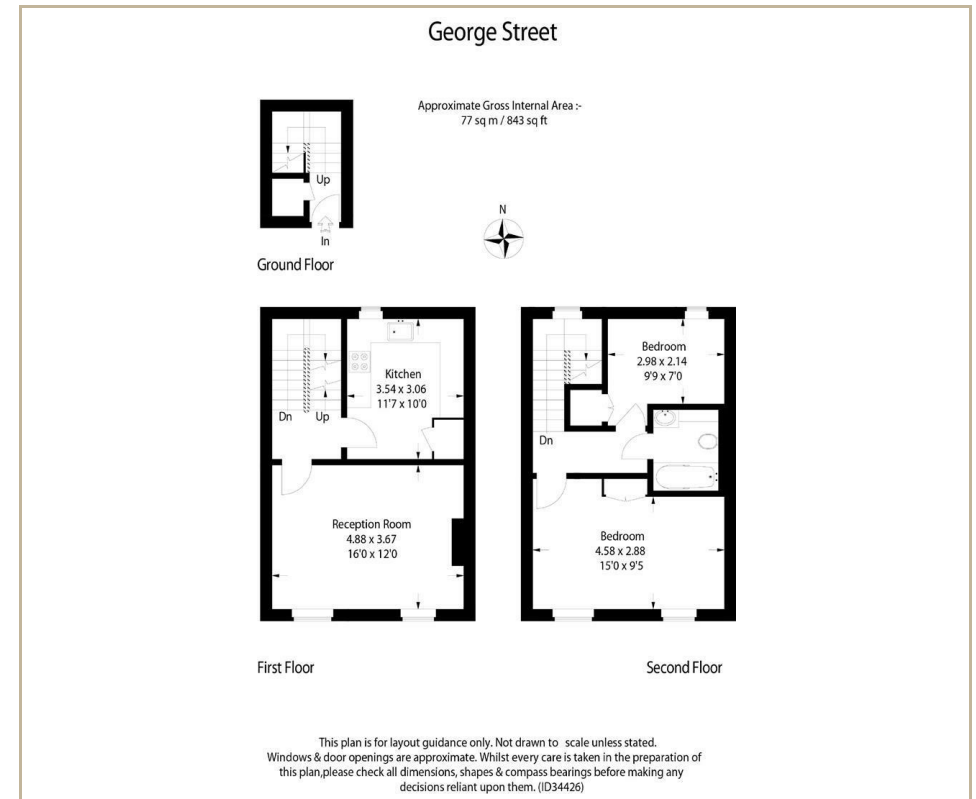

TERMS

Leasehold | 10 years

Service Charge £3,670 annual / Ground rent £100 per annum

For Clarification we wish to inform prospective purchasers that we have prepared these sales particulars as a general guide. We have not carried out a survey, nor tested the services, appliances and specific fittings. Room sizes are approximate and rounded: they are taken between internal wall surfaces and therefore include cupboards/shelves, etc. Accordingly, they should not be relied upon for carpets and furnishings. Formal notice is given that all fixtures and fittings, carpeting, curtains/blinds and kitchen equipment, whether fitted or not, are deemed to be removable by the vendor unless specifically itemised within these sales particulars.

T. +44 (0) 20 7935 0011
E. enquire@napierwatt.co.uk
WWW.NAPIERWATT.CO.UK

NAPIER WATT
PROPERTY CONSULTANTS